



UPTOWN *Hutch*

1500 E 11th Avenue, Hutchinson, KS 67501

HIGHLIGHTS

- Located 52 miles northwest of Wichita
- Serves an extensive area of western and southern Kansas
- Excellent visibility, located in the center of the retail and restaurant hub of Hutchinson
- Offers a variety of specialty shops as well as national tenants
- Home of the Kansas State Fair and the Kansas Cosmosphere and Space Center

DEMOGRAPHICS

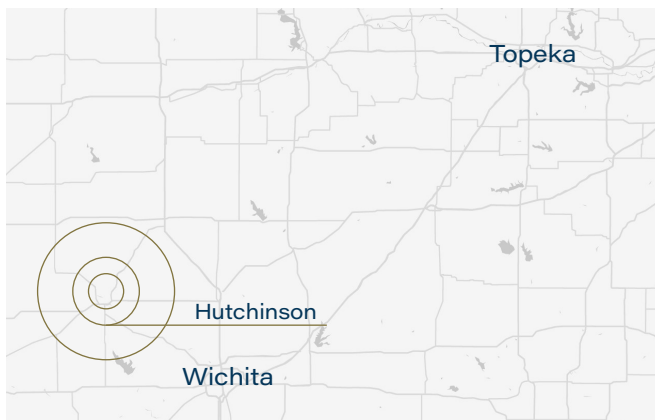

Miles	5	10	20
POPULATIONS	47,386	54,159	68,115
HOUSEHOLDS	19,301	21,887	27,159
AVG HH INCOME	\$61,601	\$63,855	\$64,693

RACINE LEAHY, DIRECTOR OF LEASING
1445 North Loop West | Suite 625 | Houston, TX 77008
314.267.6596 | rleahy@rockstep.com | www.rockstep.com

RockStep
CAPITAL

FLOOR PLAN

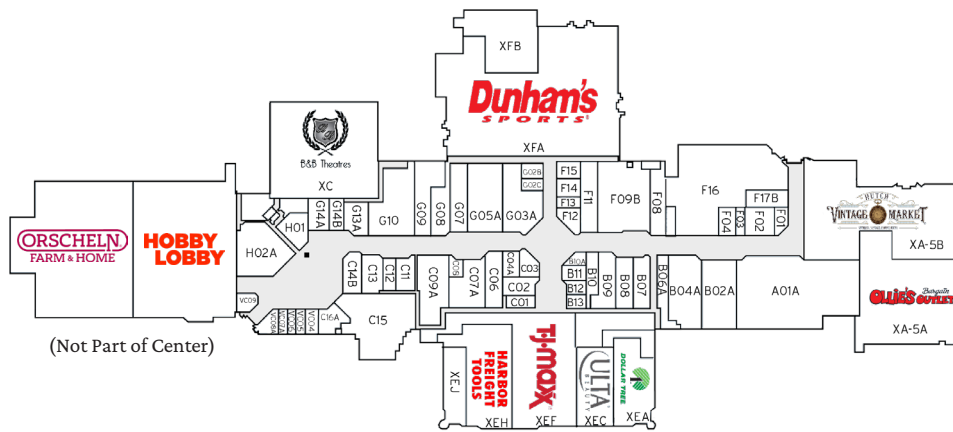

Join these national brands
at Uptown Hutch!



LOCAL AREA



This document has been prepared by RockStep Capital for advertising and general information only. RockStep Capital makes no guarantees, representations, or warranties of any kind, expressed or implied, regarding the information including, but not limited to, warranties of the content, accuracy and reliability. Any interested party should undertake their own inquiries as to the accuracy of the information. RockStep Capital excludes unequivocally all inferred or implied terms, conditions, and warranties arising out of this document and excludes all liability for loss and damages arising there from. This publication is the copyrighted property of RockStep Capital and/or its licensor(s). ©2023 All rights reserved.